

DIY Executive Style Kids Desk



These plans are currently free to email subscribers and for personal use only. They cannot be shared or sold without my permission. Please let me know if you have any questions and enjoy your build! :)

Please note, this desk size is best for grade school kids. Depending on the size of the kid, of course. Middle School and High School kids will need a bigger desk. You can always adjust this plan to add more height and a fourth drawer or a cabinet.

And, with all of this moulding and plywood, this can be a pricey build. But if you love the look and want a pretty desk with a high-end look, you'll be glad you built this.

Find the full tutorial with build photos and finish steps here: <https://abbottsathome.com/diy-kids-desk-storage-plans>

More Build Plans from Abbotts At Home here: <https://abbottsathome.com/build-plans/>

See build previews and behind the scenes, on Instagram: <https://www.instagram.com/abbottsathome/>

Abbotts At Home Tutorials and DIY Videos on YouTube: https://www.youtube.com/channel/UCck5Oq8xzRT9sacKs56kG_A/

Tools Needed

Kreg Jig, Screws and Drill
Wood Glue
Brad Nailer and Nails
Miter Saw
Sander and Sandpaper
Straight Edge Circular Saw Cutting Guide

Shopping List

Edge Banding
3 sets of 16" Bottom-Mount Drawer Slides
40' of 2x2 Dimensional Lumber
48' of 1/2" x 3/4" Moulding
36' of Cove Moulding
1 - 4' x 8' sheet of 1/4" Plywood
1 - 4' x 8' sheet of 1/2" Plywood
1 - 4' x 8' sheet of 3/4" Plywood
17' of 2 1/4" high Base Moulding
10' of Cap Moulding
10' of Panel Moulding

Desk Frame Cut List

Be sure to **double-check everything, as you build**. It's always possible that I could have mis-typed something. Bloggers don't have editors. ;) Also, I used Select Pine Dimensional Lumber, Birch Plywood, and Pine Moulding for this build.

- 6 - 25 1/4" 2x2 dimensional lumber
- 5 - 18" 2x2 dimensional lumber
- 6 - 16" 2x2 dimensional lumber
- 9 - 15 1/2" 2x2 dimensional lumber
- 18 - 15 1/2" long 1/2" x 3/4" moulding pieces
- 10 - 12 1/4" long 1/2" x 3/4" moulding pieces
- 10 - 3 1/2" long 1/2" x 3/4" moulding pieces
- 2 - 12 3/4" long 1/2" x 3/4" moulding pieces
- 2 - 15" long 1/2" x 3/4" moulding pieces
- 2 - 17" long 1/2" x 3/4" moulding pieces

Step One

We'll use 9 - 15 1/2" 2x2's and 6 - 25 1/4" 2x2's to construct the 2 desk sides and the middle of the frame. All 3 will be built the same way. Put 1 pocket hole on each end of the 9 - 15 1/2" 2x2's.

Glue and screw 3 of the 15 1/2" 2x2's between 2 of the 25 1/4" 2x2's. The first should be even with the top of the 25 1/4" 2x2's. The top edge of the second should be 6 1/2" down from the top edge of the 25 1/4" 2x2's. And the top edge of the third should be 3 1/2" up from the bottom of the 25 1/4" 2x2's. Build 3 of these.

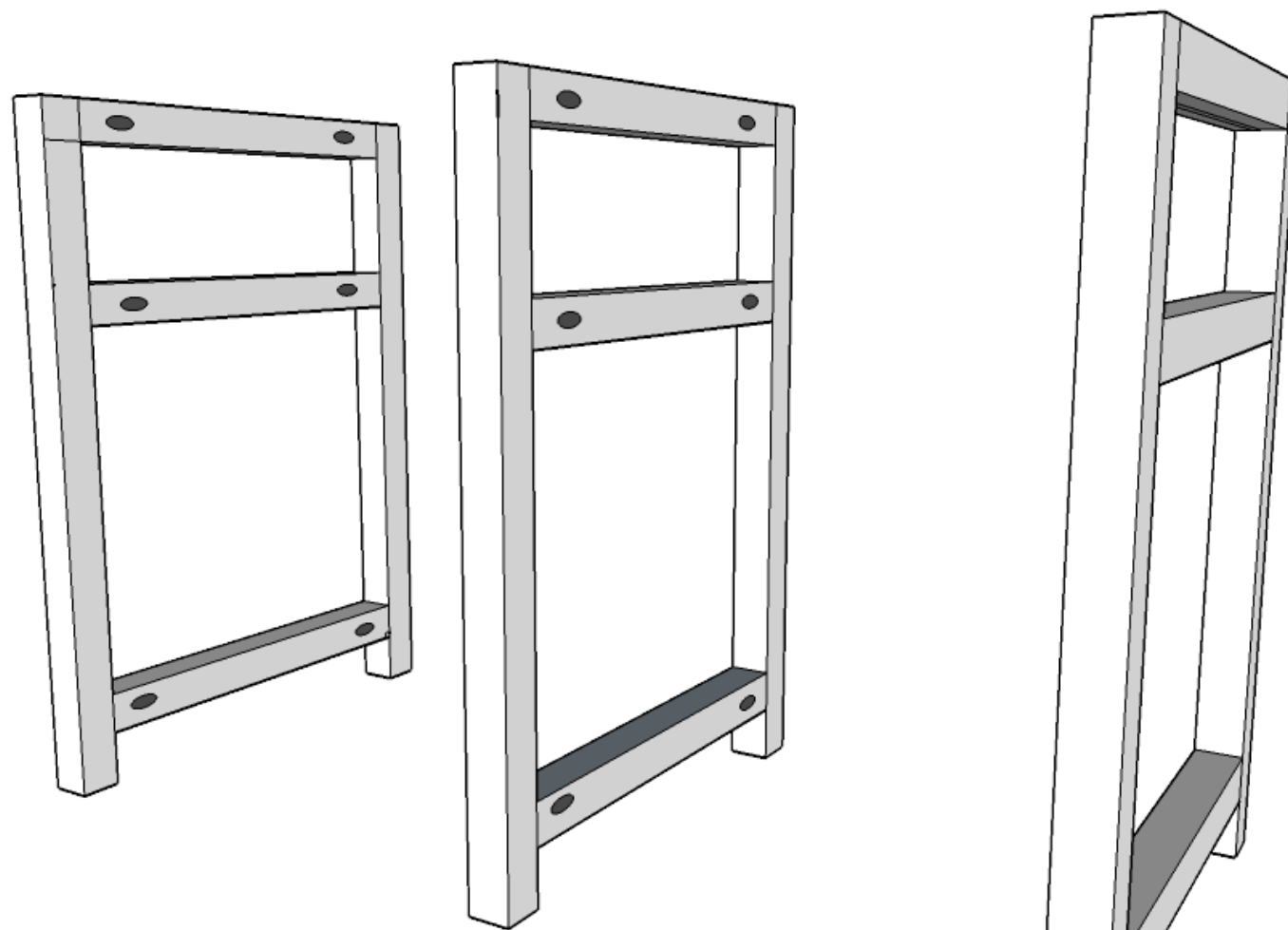

Step Two

For the chair side of the desk, put 1 pocket hole on each end of 5 - 18" 2x2's. Glue and screw 2 of the 3 frames you built in Step One together with the 5 - 18" 2x2's. 2 of the 18" 2x2's will connect the 2 frames at the top edges of the front and back of the frames. 2 of the 18" 2x2's will connect the 2 frames 6 1/2" down from the top edge. The last 18" 2x2 will connect 3 1/2" up from the bottom.

Step Three

To complete the framing, put 1 pocket hole on each end of 6 - 16" 2x2's. These will connect the third side frame to the frame you assembled in Step Two. Glue and screw 2 of the 16" 2x2's at the top edges of the front and back of the frames. 2 of the 16" 2x2's will connect the 2 frames 6 1/2" down from the top edge. The last 2 - 16" 2x2's will connect 3 1/2" up from the bottom.



Step Four

We will use 1/2" x 3/4" moulding to build a frame for the 1/4" Plywood Panels on this DIY Kids Desk with Storage. Cut 10 - 15 1/2" long 1/2" x 3/4" moulding pieces to attach to the 15 1/2" 2x2's. Glue and nail **along the 1/2" side of the moulding**, to leave enough room for the plywood and cove moulding.

BE CAREFUL, you want these in the right spot. 8 of them should be on the short sides of the desk, flush with the inside edges of the 15 1/2" 2x2's.

The other 2 will be flush with the inside of the opening for the seat on the lower part of the middle frame. If it helps explain this, you want the whole inside of the opening for the seat to look the same. So, the moulding on the left and right side should match.

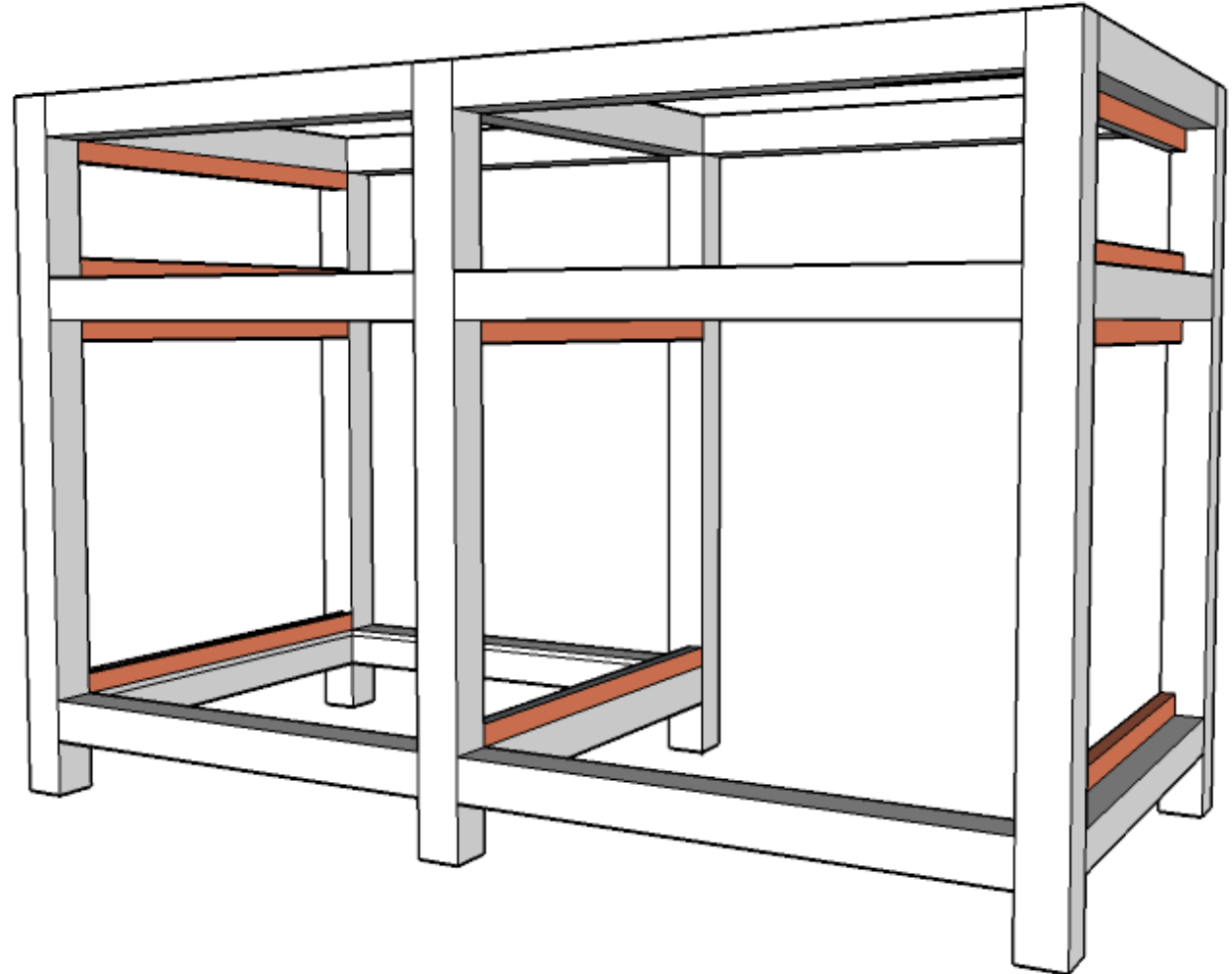

Step Five

Finish those 6 plywood panel frames with 6 - 12 1/4" long 1/2" x 3/4" moulding pieces, on the 3 larger bottom sections. And 4 - 3 1/2" long 1/2" x 3/4" moulding pieces. Glue and nail **along the 1/2" side of the moulding**, to leave enough room for the plywood and cove moulding.

Step Six

Both sides of the desk and the inside panels are done for now. Now, add 1/2" x 3/4" moulding to the back of the desk. You'll need 4 - 18" long 1/2" x 3/4" and 4 - 16" long 1/2" x 3/4" moulding pieces.

After gluing and nailing those in place (flush with the inside edge of the 2x2's), glue and nail 4 - 3 1/2" long 1/2" x 3/4" moulding pieces to the sides of the 2 top panels. And, 4 - 12 1/4" long 1/2" x 3/4" moulding pieces will finish the sides of the 2 lower panels.

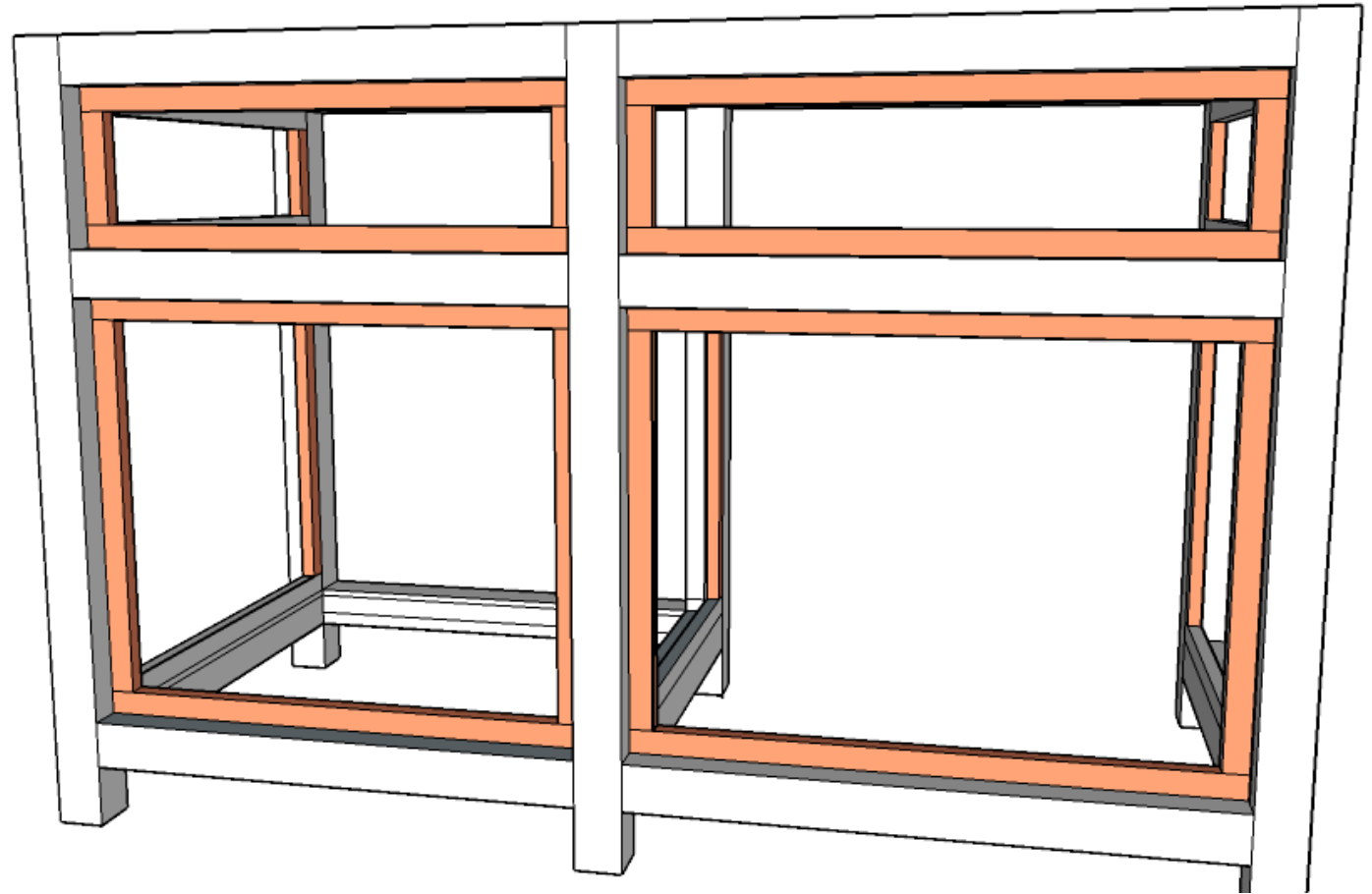

Panel Cut List

Now, let's install the 1/4" plywood panels, or Lauan board, and cove moulding. Be sure to use a smooth board, if you want a smooth finish. If you want to see grain, you can use a cheaper grade plywood.

- 2 - 15 1/2" x 5" plywood panels - 1/4" thick
- 3 - 15 1/2" x 13 3/4" plywood panels - 1/4" thick
 - 1 - 16" x 5" plywood panel - 1/4" thick
 - 1 - 18" x 5" plywood panel - 1/4" thick
- 1 - 16" x 13 3/4" plywood panel - 1/4" thick
- 1 - 18" x 13 3/4" plywood panel - 1/4" thick
- 1 - 15 1/2" x 18" plywood panel - 1/4" thick
- 1 - 15 1/2" x 16" plywood panel - 1/4" thick
- Cove Moulding cut with 45-degree angles
 - 8 - 5" long pieces
 - 8 - 15 1/2" long pieces
 - 8 - 13 3/4" long pieces
 - 4 - 16" long pieces
 - 4 - 18" long pieces

Step One

I worked one side at a time with this, flipping the desk on end to put the side I'm working on face up. **For the 2 short sides**, you'll need 2 - 15 1/2" x 5" plywood panels and 2 - 15 1/2" x 13 3/4" plywood panels.

Use glue to attach the plywood to the 1/2" x 3/4" frames. Then glue and brad nail cove moulding tightly in place, over it. For your 45-degree cove moulding cuts on the 2 short sides, you'll need: 4 - 5" long pieces, 8 - 15 1/2" long pieces, and 4 - 13 3/4" long pieces. Be sure to nail into the sides of the 2x2's, instead of through the other moulding.

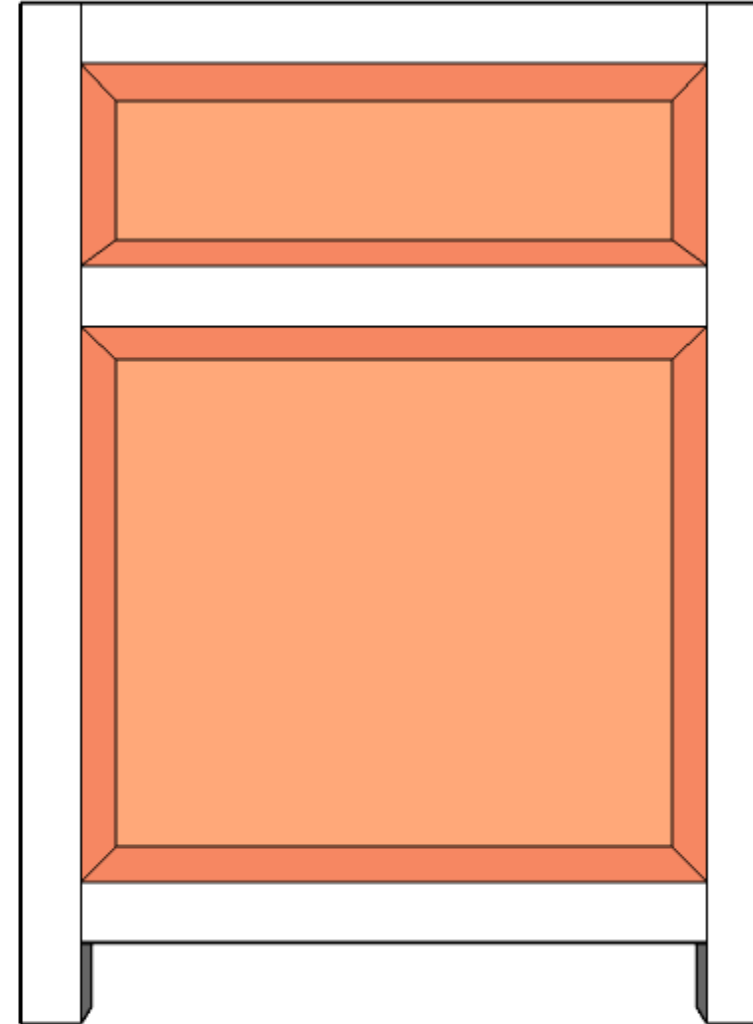

Step Two

Now, you can finish the back of the DIY Kids Desk with Storage. You'll need 1 - 16" x 5" plywood panel, 1 - 18" x 5" plywood panel, 1 - 16" x 13 3/4" plywood panel, and 1 - 18" x 13 3/4" plywood panel. Glue those in place. Then glue and brad nail the cove over each panel.

For your 45-degree cove moulding cuts, you'll need: 4 - 5" long pieces, 4 - 16" long pieces, 4 - 18" long pieces, and 4 - 13 3/4" long pieces. Be sure to nail into the sides of the 2x2's, instead of through the other moulding.

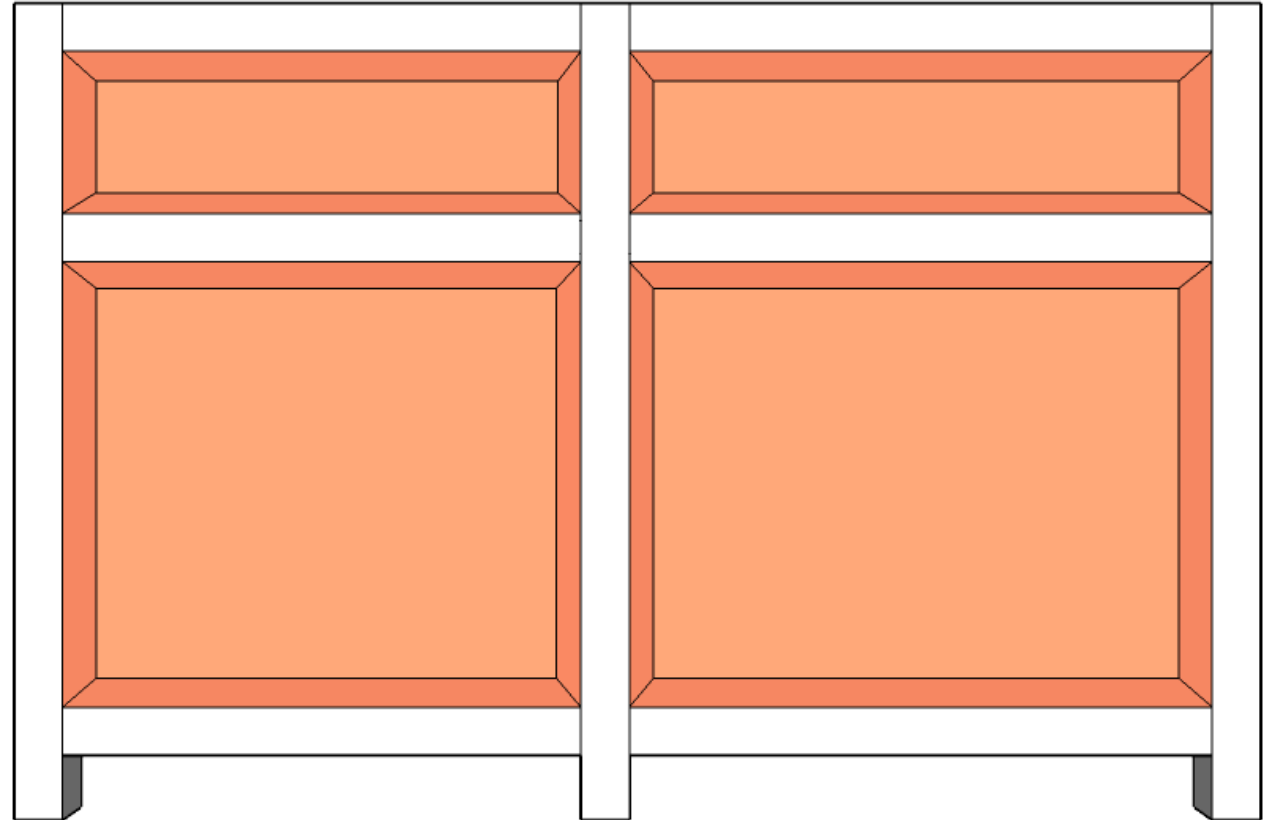

Step Three

Next, we'll add a panel to the lower, right-hand side of the chair opening. You'll need 1 - 15 1/2" x 13 3/4" plywood panel. Glue it to the frame you built. Then frame in the bottom and top of the other side with 2 - 15 1/2" long 1/2" x 3/4" moulding pieces. **BUT THIS TIME** glue them 3/4" side down **AND FLUSH** with the edge of the 2x2.

This is really important because it will be where you'd attach your drawer slides. So, you want everything flush and square to make sure the slides will work. Finish that panels moulding with 2 - 12 3/4" long 1/2" x 3/4" on the sides.

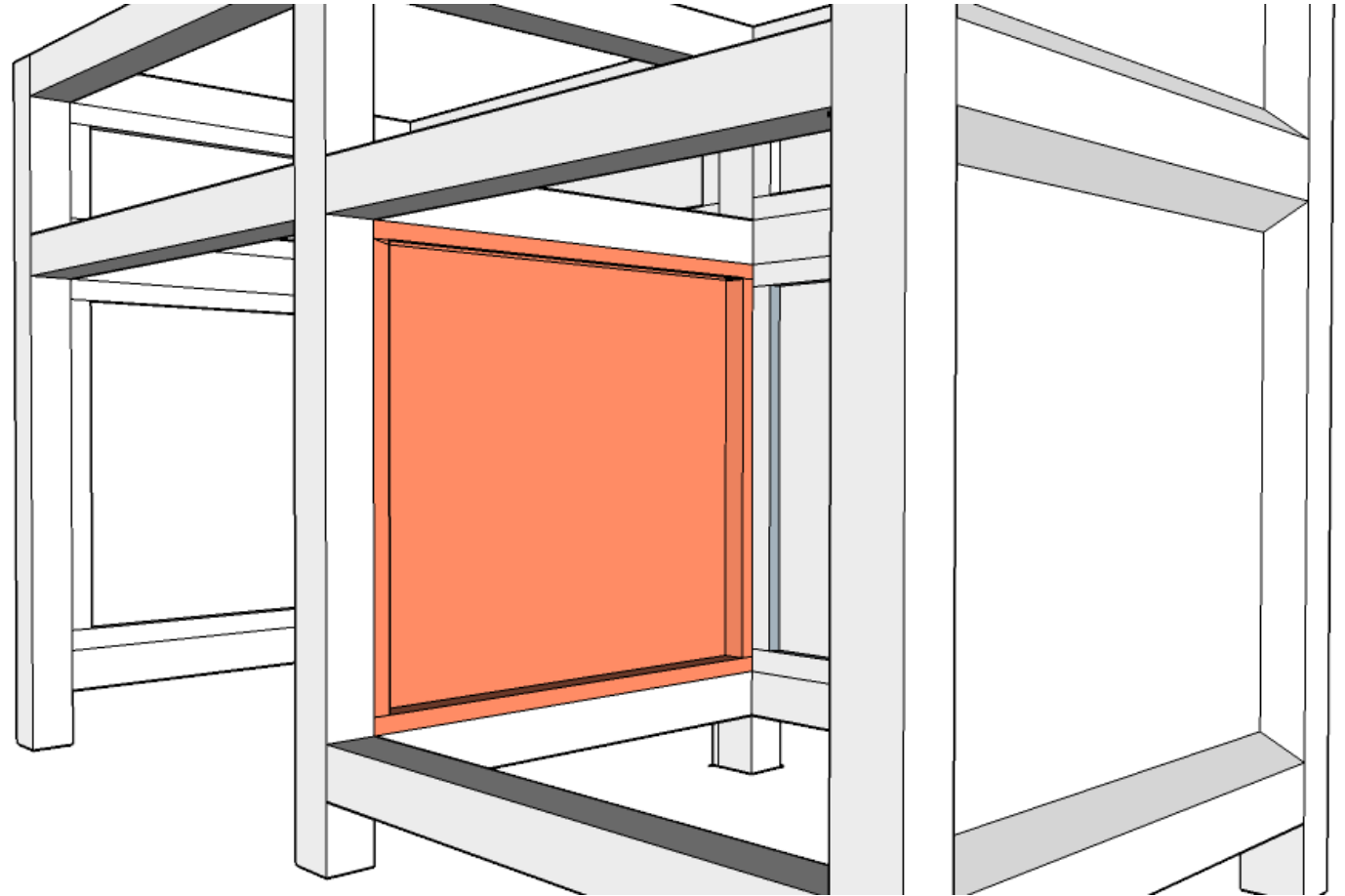

Step Four

Then add 2 - 15 1/2" long 1/2" x 3/4" moulding pieces between the 2 smaller drawers at the top. Each one should be glued and nailed on the 1/2" sides and flush with each side of the 2x2. These will be used for the drawer slides again.

Step Five

Now, we'll attach 2 drawer bottoms. You need 1 - 15 1/2" x 18" plywood panel and 1 - 15 1/2" x 16" plywood panel. Use 4 - 15 1/2" long 1/2" x 3/4" moulding pieces, 2 - 15" long 1/2" x 3/4" moulding pieces, and 2 - 17" long 1/2" x 3/4" moulding pieces to build support frames for the panels.

Glue and nail the moulding to the 2x2's 1/4" down from the top of the 2x2, so that the plywood panels will sit flush with the top of the 2x2's. Then glue the panels to the top of those frames.

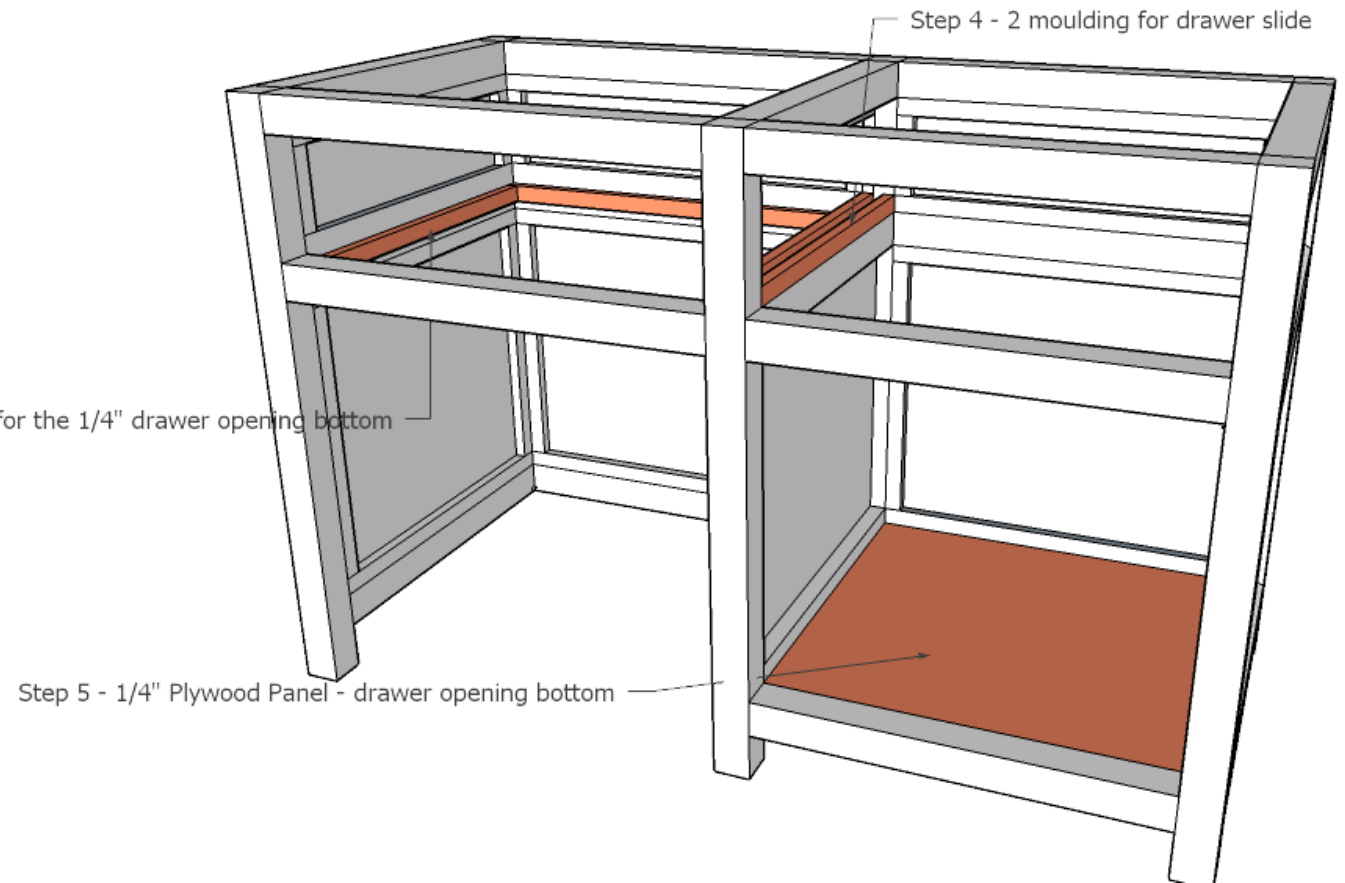

Desk Drawers Cut List

I used 1/2" Birch Plywood for the drawer fronts, 1/2" Plywood for the drawer frame, and 1/4" plywood for the drawer bottoms.

Drawer Frame

- 6 - 3 3/4" x 16" x 1/2" plywood
- 2 - 3 3/4" x 14" x 1/2" plywood
- 2 - 12 1/4" x 14" x 1/2" plywood
- 2 - 12 1/4" x 16" x 1/2" plywood

Drawer Bottoms

- 1 - 17" x 16" x 1/4" plywood
- 2 - 15" x 16" x 1/4" plywood

Drawer Faces

- 15 13/16" x 4 13/16" x 3/4" plywood
- 17 13/16" x 4 13/16" x 3/4" plywood
- 15 13/16" x 13 9/16" x 3/4" plywood

We're ready to build our drawers. Yasss! All 3 drawers will be 16 inches deep. I used 16" Bottom Mount Euro Drawer Slides. So, the slides required 1/2" clearance on each side.

Make sure to check the directions for the slides you buy. The requirements may be different. You might have to adjust your drawers for the slides you use.

Also, you can use soft close, side mounted drawer slides. Just adjust the drawer plans per the slides and add moulding or 1/2" plywood where the slides will be mounted inside the desk. I'd also recommend an inset drawer bottom for side-mounted drawer slides. It's stronger when bottom-mount slides aren't helping support the weight. And, looks prettier.

Step One

You'll build 3 box frames for this DIY Kids Desk with Storage. With the **drawer sides being the 16" long pieces**. Use glue and nails to construct. You could use pocket holes, but I think it's overkill for drawer sides and makes lining up a square box harder. Good wood glue is strong enough here. The Brad Nails hold it tight together while the glue dries.

The top left box is 2 - 3 3/4" x 16" x 1/2" plywood and 2 - 3 3/4" x 16" x 1/2" plywood. The top right box is 2 - 3 3/4" x 16" x 1/2" plywood and 2 - 3 3/4" x 14" x 1/2" plywood.

The bottom right box is 2 - 12 1/4" x 14" x 1/2" plywood, and 2 - 12 1/4" x 16" x 1/2" plywood pieces. Remember, the 16" pieces are the drawer sides.

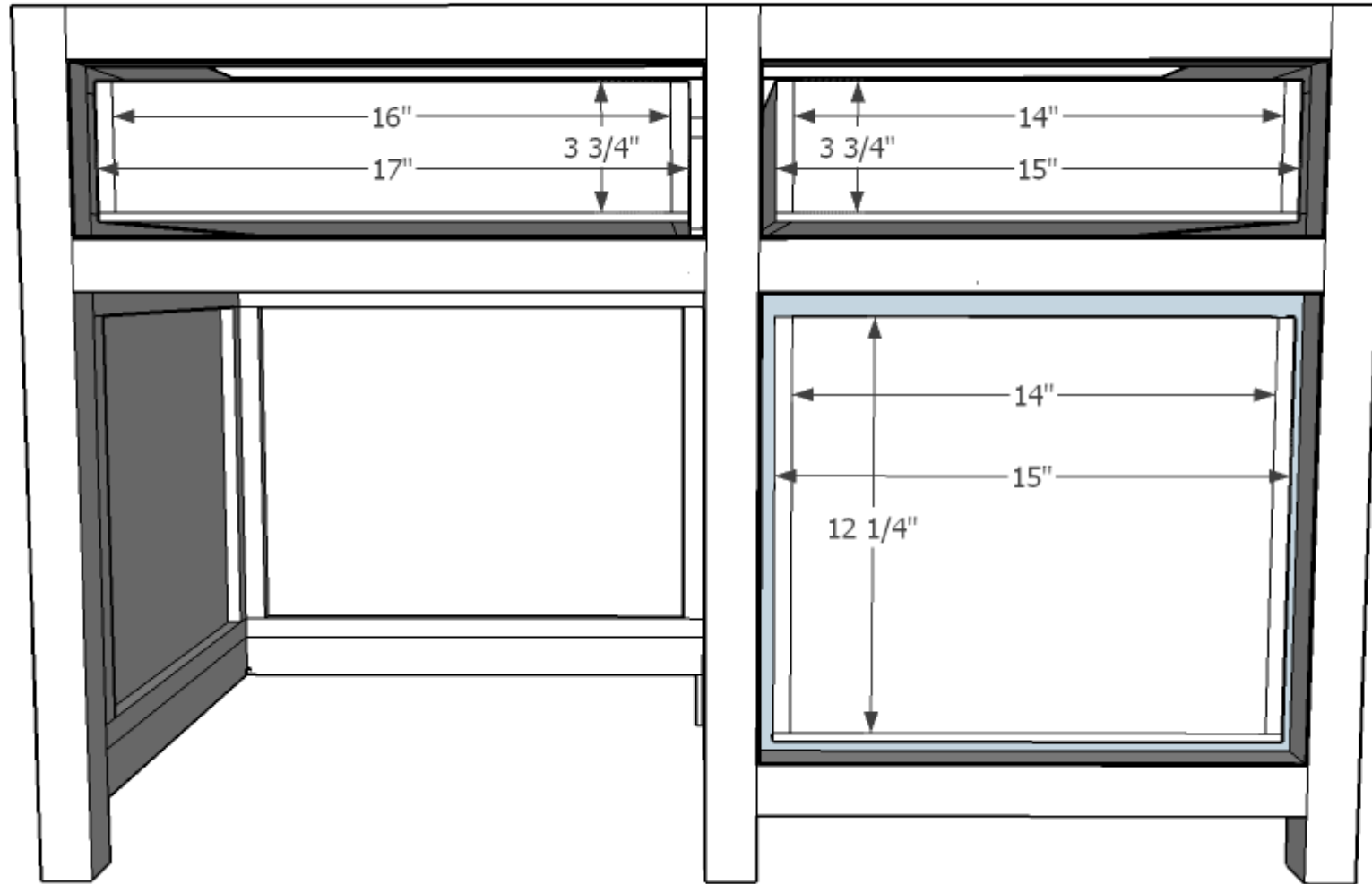

Step Two

Glue and Nail 1/4" plywood bottoms onto the 3 boxes. Top left bottom is 17" x 16". The 2 right-side drawers are 15" x 16". Gluing and nailing is strong enough here because the Euro slides will carry the load on the drawer.

Step Three

Install drawers using the drawer slides, per slide instructions. Make sure drawer sits inset 3/4" from outside of frame to allow for drawer face. I set my drawer slides as close to the bottom of the drawer opening as possible. Adjust drawer slides until you are satisfied with how the drawer opens/closes. You may need to add more moulding, if your slides are set higher than mine.

Step Four

Apply Birch edge-banding around all 4 sides of the drawer faces. Place drawer face on installed drawers, **with a 1/16" gap** on all sides of drawer face. Temporarily hold in place with 1" finish nails, double-sided tape, or hot glue. Then clamp face for extra security and screw on face from inside of drawer.

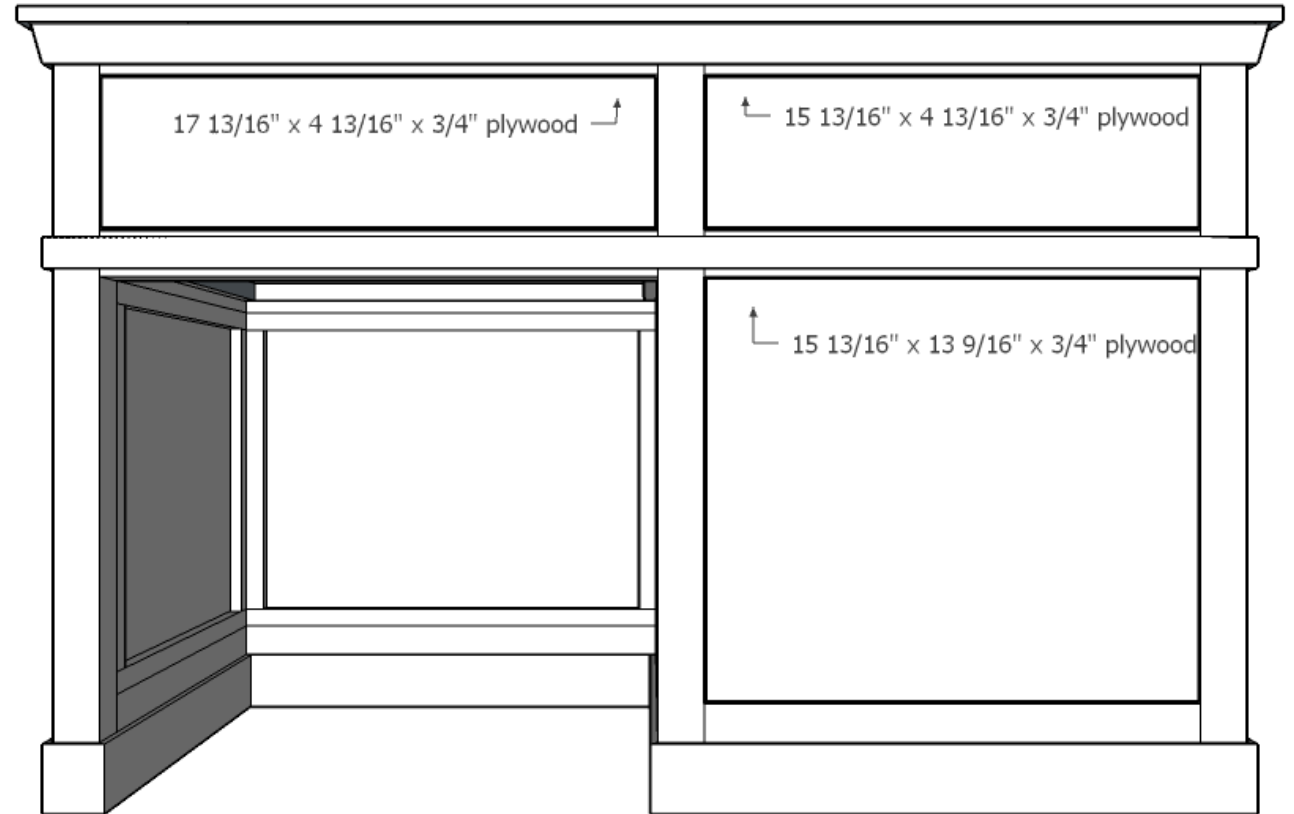

Moulding & Top

I find with trim moulding, it's best to measure and cut as you go. This helps you get the tightest fit and account for any slight differences in build. It also helps you focus on which direction the 45-degree angle should be cut on each end of the trim.

I used about 17' of 2 1/4" high door casing around the bottom of the desk. About 10' of Panel Moulding, similar to this, centered on the middle 2x2 rails. And, about 10' of cap moulding along the top edge.

Based on which base cap you pick, you may need to adjust the desk top. My desk top is 40 1/8" x 20 1/8" x 3/4" Birch Plywood. That leaves about 1/4" overhang on all edges. I finished the desk top with edge-banding, applied with an iron.

DO NOT ATTACH the top until the desk is finished. Now, fill all holes and imperfections with wood filler and let dry. Repeat as needed. Then sand the project in the direction of the wood grain with 120 grit sandpaper. Brush clean or vacuum away dust.

Follow up with a slightly damp tack cloth or scrap cloth, to get it extra clean. You may also need to use primer or wood conditioner, based on your finish.

Attach the desk top with glue and nails OR angle brackets OR pocket holes. Add some pulls you love and that's it! You're done. Enjoy you're new DIY Kids Desk with Storage. :)

See my full finishing steps on my site: <https://abbottsathome.com/diy-kids-desk-storage-plans>

